

***Greater Atlanta Australian
Shepherd Club***

<http://www.gaasc.org>

Spring Fling 2012

March 16-18, 2012

**4 ASCA Stockdog Trials &
1 ASCA Farm Trials
(sheep/cattle/ducks/mixed)**

**Bartow Co Saddle Club,
Cartersville, GA**

<http://www.bartowcountysaddleclub.com/>

**Belt Buckles awarded for High in
Trial and Most Promising Started
Aussie** (Sponsored by Island Time Pools)



Cheryl Padgett
445 Shinall Gaines Rd, NW
Cartersville, GA 30121



WE APPRECIATE TEAM PLAYERS! We need people to help. This is a great way to learn something more about events you would like more experience with. Contact any event secretary & let them know how you can help. Thank you!

For complete rules and regulations on any ASCA programs, visit the ASCA web site at <http://www.asca.org>, or call ASCA at 979-778-1082

SPECIAL RECOGNITION:

The Suzanne Kinman Memorial Award

awarded to the highest scoring Aussie from the arena trials who also shows in conformation (tied trial score broken by cattle). Sponsored by Wildfire Aussies

Awards:

Stockdog Trials: Buckles for High Combined & Most Promising Started Aussie (sponsored by Island Time Pool)

Ribbons award for 1st through 4th place

Rosettes for High In Trial, High In Trial Aussie

Rosette for High Scoring Champion of Record (Please let us know if you qualify for this)

Rosette for New WTCH Title

HIT Farm: (sponsored by Hardrock Aussies)

Greater Atlanta Australian Shepherd Club, Jubilee March 16-18, 2012

Bartow County Saddle Club Arena, Cartersville, GA

Stockdog Event Chairman – Cheryl Padgett, hardrockaussies@yahoo.com, 404-216-5152

Friday, March 16, Farm Trials, Judge Wayne Kirby

Day of entry – 7-7:30, handlers meeting at 7:30, trials begin at 8 am. **Stock run order will be announced at the handler's meeting.**

Sheep (Hair Mix), cattle (Beef Mix), ducks (Mix), mixed sheep/cattle

Sheep and Cattle Farm Trials will be held at the sale barn located 100 feet beyond Bingham Rd. on the right. The Duck Farm Trial will be held at the Bartow County Saddle Club.

Specifications for all Farm Trials listed at the end of this premium.

Sheep & Cattle arena trials under cover at the Bartow County Saddle Club. Ducks trials open air on grass.

Saturday, March 17

	Judge	Registration Judging		
Stock – 1st	Wayne Kirby	7-7:30 AM	8 AM	Course B
Stock – 2 nd	Rick Hardin	7-7:30 AM	8 AM	Course B

Handler's meeting at 7:30 a.m. Stock run order will be announced at the handler's meeting.

Sunday, March 18

	Judge	Registration Judging		
Stock – 1st	Rick Hardin	7-7:30 AM	8 AM	Course A
Stock – 2 nd	Wayne Kirby	7-7:30AM	8 AM	Course A

Handler's meeting at 7:30 a.m. Stock run order will be announced at the handler's meeting.

Stock will be run concurrently beginning with Cattle and Ducks. Both Sheep trials will be run after both Cattle and Duck trials are completed.

Pre-entries open February 1, 2012. All pre-entries must be postmarked by March 9, 2012.

Please use the Official ASCA Entry Forms attached with this flier.

Make checks payable to GAASC and mail all entries to:

GAASC, c/o Cheryl Padgett, 445 Shinall Gaines Rd, NW, Cartersville, GA 30121

There will be a \$35.00 service charge for any returned checks. Refunds issued up to pre-entry deadline. Substitutions allowed with dogs that you own or co-own.

Farm Trial	Pre-entry	Day of (if available)	Arena Trials	Pre-entry	Day of (if available)
Sheep	\$45	\$55	Sheep	\$35	\$45
Cattle	\$50	\$60	Cattle	\$45	\$55
ducks	\$30	\$40	ducks	\$25	\$35
mixed	\$50	\$60			
All 4 classes	\$150	\$190	All 3 classes	\$90	\$120

FACILITY: There is a large parking area with plenty of room for RV parking overnight. Self contained RVs only (no water, no electric and absolutely no dumping of gray and/or black water tanks on the show facilities). The only electricity is on poles under the barn and can only run dryers or fans. Electric use is \$10/day.

Directions to show site: 50 Saddle Club Dr SW Cartersville, GA 30120 (address for GPS) From I-75 Exit #290 - go west on Hwy 20. Go past Wal-Mart on left to the next traffic light. Turn left and then an immediate right onto Joe Frank Harris Parkway. Go to 2nd traffic light at Grassdale Rd. Turn left on Grassdale Rd. then an immediate right onto Iron Belt Rd. Iron Belt Road dead ends at a stop sign, turn left to continue on Iron Belt Rd. Iron Belt Road dead ends into Burnt Hickory Rd. Turn right on Burnt Hickory Rd. then turn left at the next road. (Bingham Rd. across from cattle sale barn) Take 1st road on left at Bartow County Saddle Club sign.

Hotels -*Double check pet policy before booking your rooms.*

Microtel Inn and Suite – 1348 Joe Frank Harris Pkwy, Cartersville, GA (678) 605-9331 – this is our Host motel. Special rates available.

Days Inn - 5618 Hwy. 20 Se, Cartersville, GA (770) 382-1824

Best Western Garden Inn & Suites - 5663 Highway 20 NE, Cartersville, GA (770) 386-1569

Hampton Inn - 5600 Hwy. 20 Se, Cartersville, GA (770) 382-8999

Knights Inn - 420 E Church St, Cartersville, GA (770) 386-7263 **Quality Inn -235 S. Dixie Ave., Cartersville, GA (770) 386-1361**

Red Roof Inn – 28 Hwy 20 Spur, I-75 exit 290, Cartersville, GA (770) 387-1800

Please, no dog washing in the motels, and **pick up after your dog** on the motel and show grounds.

Veterinarian Services:

Westside Animal Hospital: Dr. Lisa Walker. 201 Doulthit Ferry Rd. Cartersville, GA 30120 (770) 607-3055. Emergency after hours (770) 547-9153 <http://www.cartersvillevets.com/westside-animal-hospital/>

Taff, William DVM Large Animal Veterinary Hospital. 1482 Old Alabama Road, Taylorsville, GA (770) 382-7475



**ASCA SERVICE
MEMBERSHIP
AND
TRACKING NUMBER**

Beginning 1/1/2003 for non-ASCA registered dogs – In order to have ASCA qualifying legs tracked and to receive ASCA titling certificates, each non-ASCA registered dog will be required to have an ASCA Tracking Number. This is a one-time fee of \$10/dog. At the time of applying for the tracking number, the individual owner must also be an ASCA member (minimum membership type of Service is required). ASCA membership does not need to be maintained in subsequent years. It will be the responsibility of the owner to identify to ASCA the shows and legs earned when applying for a Tracking Number for those ASCA qualifying legs earned from 1/1/2003 until submission of application.

Please type or print clearly. Incomplete or illegible forms will be returned.

Membership Application:

Owner's Name (1) _____

Owner's Name (2) _____

Owner's Address: _____

City, State, Postal Code: _____

Phone Number: _____ E-mail: _____

Type of Membership: Service (\$8) This form for Service Membership only.
(If you would like to become a full member use the official ASCA Membership Application)

Application Type: New Renewal Existing Member Mem.# _____

I (We) agree to abide by the ASCA Articles of Incorporation, Bylaws, and all ASCA Rules and Regulations governing the ASCA Registry and all other ASCA programs.

Owner's Signature (1): _____

Owner's Signature (2): _____

Dog Information: Lifetime fee for tracking number is \$10.00 per dog for ASCA Members

Dog's Full Name: _____

Dog's Call Name: _____

Any/All Previous Registration Numbers Used: _____

Sex: _____ Birthdate: _____

Breed: _____

Mail completed form with check or money order to:

**ASCA Business Office
PO Box 3790, Bryan, TX 77805-3790**

Farm Trial Diagrams – Nov 4th, 2011

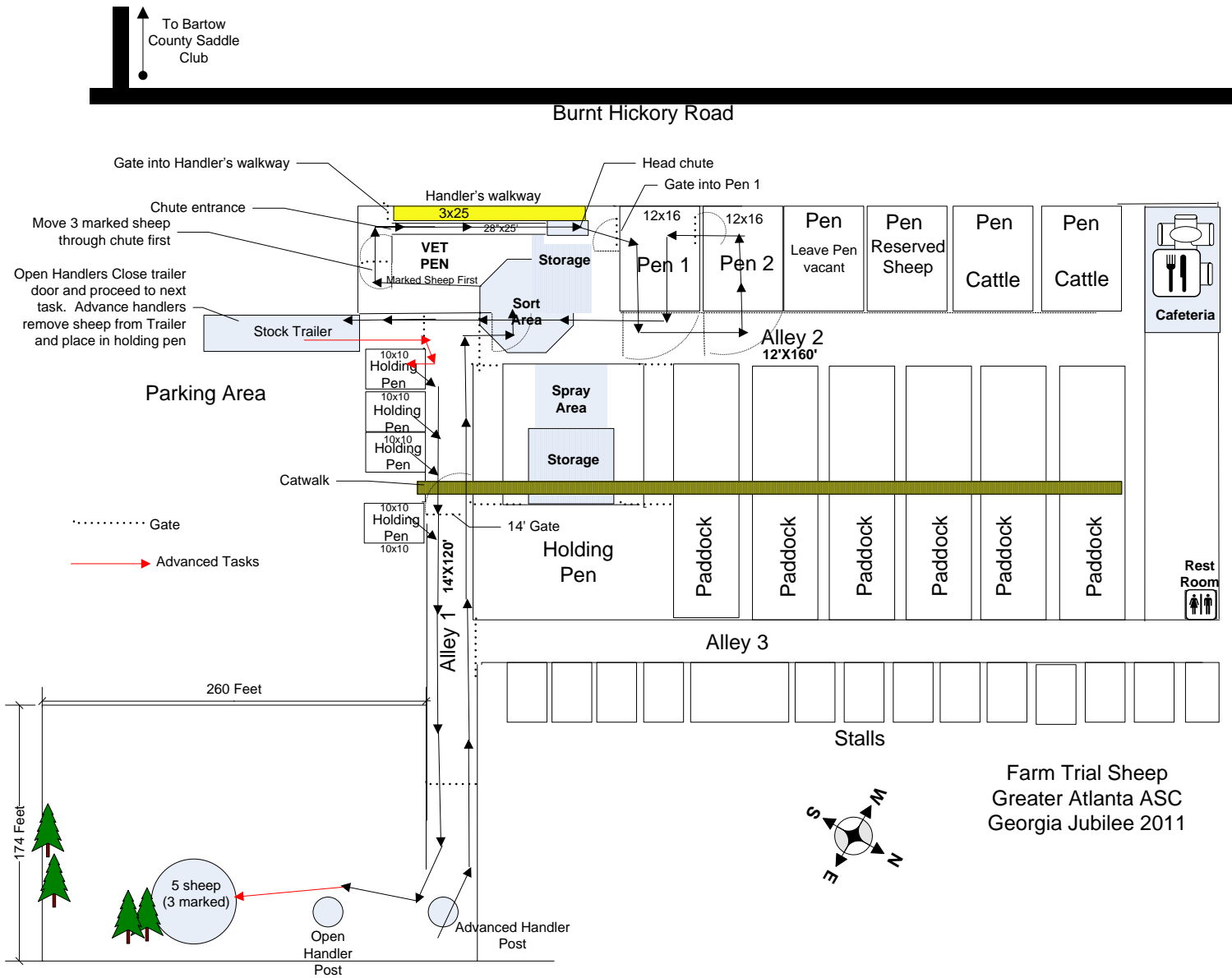

Greater Atlanta ASC

Farm Trial Dog (Sheep)

March 16, 2012

All dogs must attempt the task in order listed. Extra duties for Advanced dogs are indicated

You may use any gate to adjust the size of your working area as long as there is no stock behind the gate and you return the gate to its original position before continuing to the next task. All gates must be in their original position before time is called.

1. Gather – 25 points

- Send your dog to gather the 5 sheep from the field. The dog must be placed at the gate regardless of the level. Open handler may go halfway to the sheep then send the dog. Advanced handler and dog must start at the gate but the handler may go halfway once the dog is sent. Time will start when the dog moves.

2. Sort – 25 points

- Once gathered drive or fetch the sheep up Alley 1 into Alley 2 toward the Vet Pen. Sort the 3 marked sheep and move them into the chute ahead of the two unmarked sheep. You may either sort the sheep from Alley 2 into the Vet Pen or from the Vet Pen into the chute entrance area.

3. Chute work – 25 points

- Move all the sheep into the chute and up to the head chute. Handlers must stay on the walkway and secure the walkway gate before moving on to the Pen work.

4. Pen Work –25 points

- Open the head chute and direct the sheep into Pen 1 through the back gate and close the gate. Return the head chute to its original closed position. Move the sheep from Pen 1 into Alley 2 and then into Pen 2. Move sheep through Pen 2 back into Pen 1 using the smaller gate at the back of the Pen.

5. Special Task (1) Trailer –15 points

- Move all 5 sheep down Alley 2 to and place on trailer. Open handlers close the trailer door and move onto next task. Advanced handlers close trailer door, then remove the sheep to open holding pen designated by course director.

6. Special Task (2) Setup and hold –15 points

- Remove 5 fresh sheep from a holding pen designated by course director and move along Alley 1 to the gather area. Open handlers may accompany their dog to the gather area; advanced handlers cannot go past the open handler's post. Once the sheep are settled to the judge's satisfaction execute a call-off command to your dog and leave the field.

Remember, time will not end until all gates are returned to their original position.

Handlers will have 20 minutes to complete the course. A warning will be given at 10 minutes and 3 minutes

To Bartow
County Saddle
Club

Burnt Hickory Road

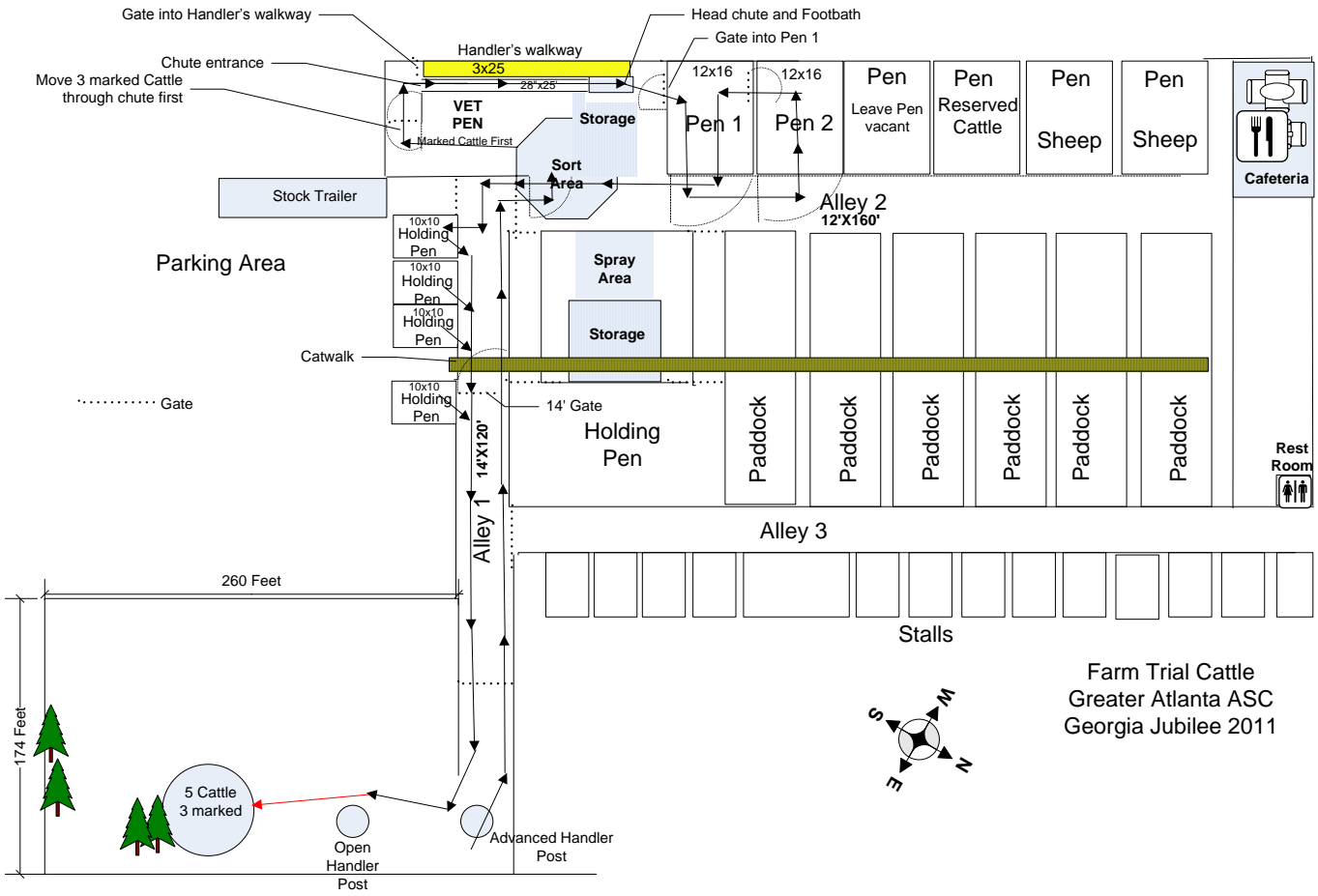

Greater Atlanta ASC

Farm Trial Dog (Cattle)

March 16, 2012

All dogs must attempt the task in order listed. Extra duties for Advanced dogs are indicated

You may use any gate to adjust the size of your working area as long as there is no stock behind the gate and you return the gate to its original position before continuing to the next task. All gates must be in their original position before time is called.

1. Gather – 25 points

- Send your dog to gather the 5 cattle from the field. The dog must be placed at the gate regardless of the level. Open handler may go halfway to the sheep then send the dog. Advanced handler and dog must start at the gate but the handler may go halfway once the dog is sent. Time will start when the dog moves.

2. Sort – 25 points

- Once gathered drive or fetch the cattle up Alley 1 into Alley 2 toward the Vet Pen. Sort the 3 marked cattle and move them into the chute ahead of the two unmarked cattle. You may either sort the cattle from Alley 2 into the Vet Pen or from the Vet Pen into the chute entrance area.

3. Chute work – 25 points

- Move all the cattle into the chute and up to the head chute. Handlers must stay on the walkway and secure the walkway gate before moving on to the Pen work.

4. Special Task (1) –15 points

- Open the head chute and direct the cattle through the simulated foot bath located inside the head chute and into Pen 1 through the back gate. Return the head chute to its original closed position once all cattle have had their foot bath and the dog clears the head chute.

5. Pen Work –25 points

- From Pen 1 move the cattle into Alley 2 and into Pen 2. From Pen 2 move the cattle through rear gate back into Pen 1. From Pen 1 move the cattle into Alley 2 and place in holding pen along Alley 1.

6. Special Task (2) Setup and hold –15 points

- Remove 5 fresh cattle from a holding pen designated by course director and move along Alley 1 to the gather area. Open handlers may accompany their dog to the gather area; advanced handlers cannot go past the open handler's post. Once the stock is settled to the judge's satisfaction execute a call-off command to your dog and leave the field.

Remember, time will not end until all gates are returned to their original position.

Handlers will have 25 minutes to complete the course. A warning will be given at 10 minutes and 3 minutes

GAASC Farm Trial Ducks March 2012
arena size 90' x 60'

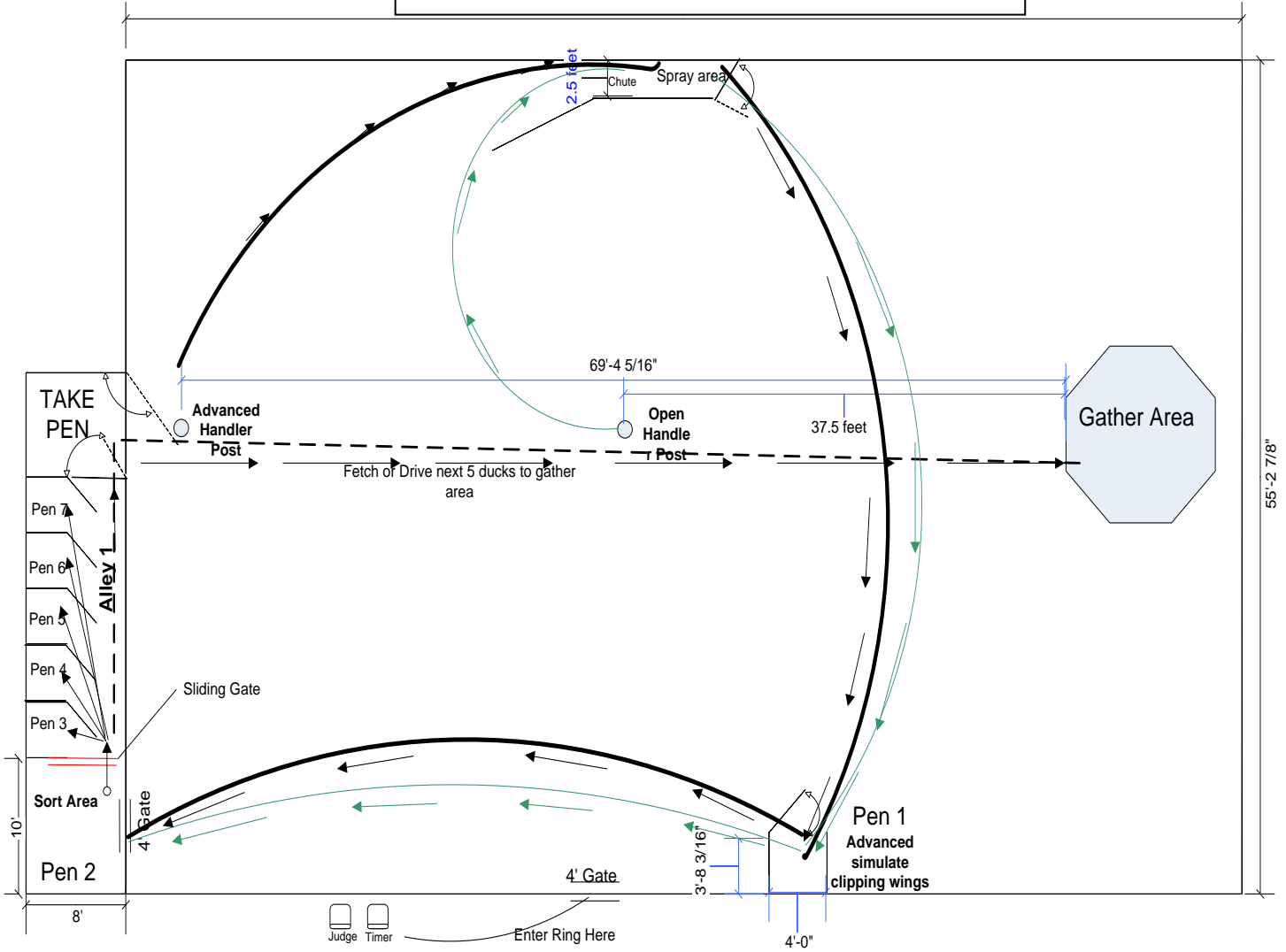

Judge Timer Enter Ring Here

55'-2 7/8"

Greater Atlanta ASC
Farm Trial Dog (Ducks)

March 16, 2012

All Dogs must attempt the following task in the order listed. Extra duties for advanced dogs are indicated.

1. Gather - 25 points

- The Dog must be placed at the Advanced handler post regardless of your level.
- Open handlers may start the gather from the half way point
- Advanced handlers and dog must start at the Advanced Handler's post but handler can go half way once the dog is sent.
- Time will start when the dog moves.

2. Chute work - 25 points

- Move ducks from your respective handlers post into the chute located on the side of the arena and into the Spray area.

2a Special Task 1 (Open Only) - 15 points

- Have you dog hold them their while you simulate spraying ducks with insecticide.
- Open gate at end of chute and have your dog move them back into the arena.

3. Pen work (1) - 25 points

- Pen the ducks in Pen 1.

3a Special Task 1 (Advanced Only) - 15 points

- Advanced handlers simulate trimming the wings
- Remove ducks from Pen 1 and close the gate. Move ducks to gate at the end of the arena leading into Pen 2.

3b Pen work (2)

- Pen the ducks in Pen 2.

5. Sort Work - 25 points

- Sort 3 ducks into Alley 1 and into an available holding pen and close the holding pen door.
- Move remaining ducks into Alley 1 and into the same holding pen. Close door and proceed to the take pen.

6. Special Task (2) (Open and Advanced) - 15 points

- Remove ducks from take pen (Pen 8) and drive or fetch to the gather area for next run. Run ends when stock are settled and dog is called off the stock.

All gates must be closed before proceeding to the next task.

The time limit is 15 minutes with a 5 minute warning.

Ties will be broken by the gather points

Bitches in heat will run in order

You must complete or attempt to complete each task before moving to the next.

To Bartow
County Saddle
Club

Burnt Hickory Road

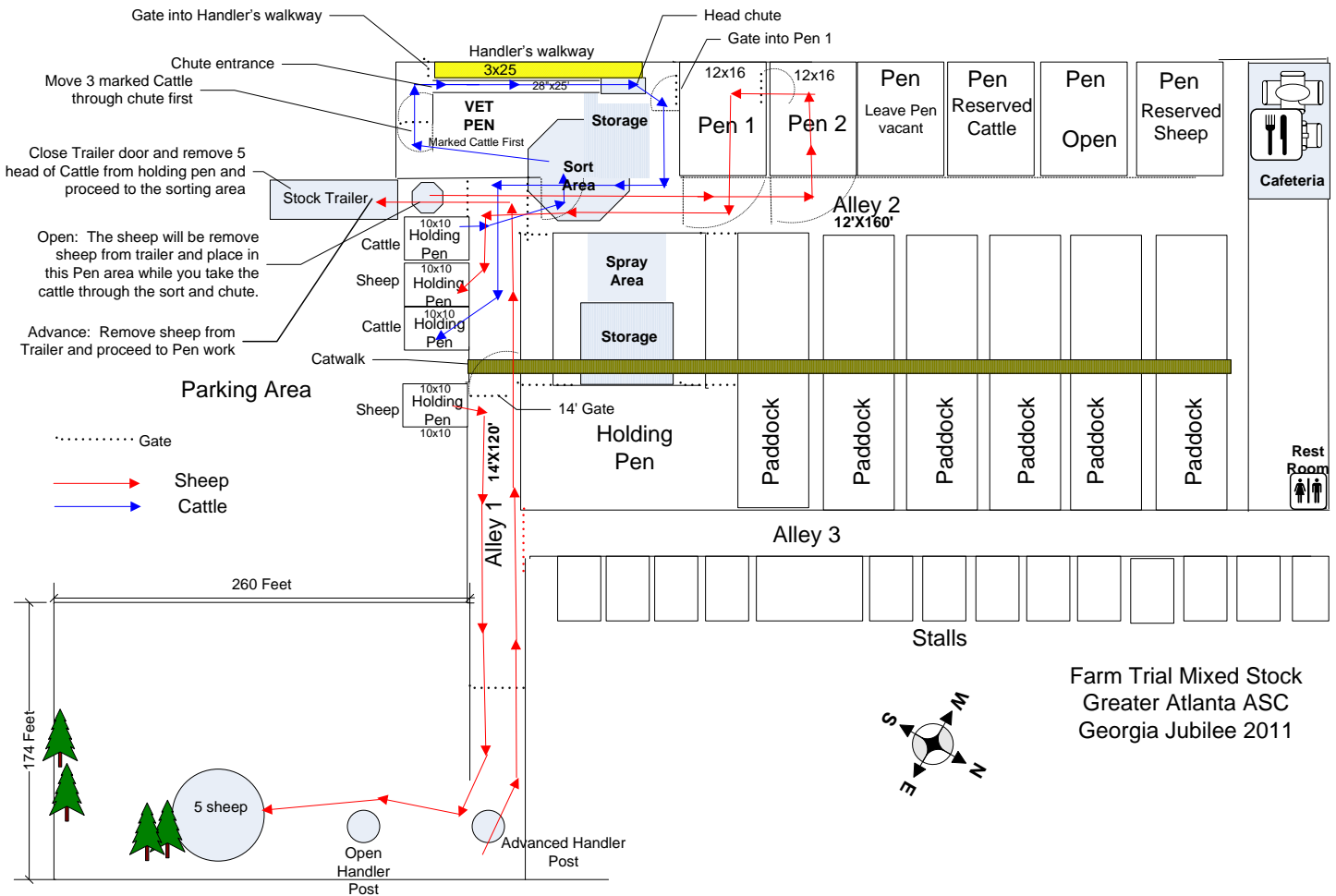

Greater Atlanta ASC

Farm Trial Dog (Mixed)

Sheep and Cattle

March 16, 2012

All dogs must attempt the task in order listed. Extra duties for Advanced dogs are indicated

You may use any gate to adjust the size of your working area as long as there is no stock behind the gate and you return the gate to its original position before continuing to the next task. All gates must be in their original position before time is called.

1. Gather – 25 points

- Send your dog to gather the 5 sheep from the field. The dog must be placed at the gate regardless of the level. Open handler may go halfway to the sheep then send the dog. Advanced handler and dog must start at the gate but the handler may go halfway once the dog is sent. Time will start when the dog moves.

2. Special Task (1) Trailer –15 points

- Move all 5 sheep up Alley 1 to and place on trailer and close the trailer door.

3. Sort – 25 points

- Remove 5 cows from holding pen designated by course director and move to sorting area. Sort the 3 marked cows and move them into the chute ahead of the two unmarked cows. You may either sort the cattle from Alley 2 into the Vet Pen or from the Vet Pen into the chute entrance area.

4. Chute work – 25 points

- Move all the cattle into the chute and up to the head chute. Handlers must stay on the walkway and secure the walkway gate. Move the cattle back to Alley 2; you may move them through Pen 1 if you like. Take the cattle to a holding pen on Alley 1 designated by the course director. Be sure to close the head chute.

5. Pen Work –25 points

- Open Handlers take the Sheep from the holding area outside the trailer.
- Advanced handlers take the Sheep from the trailer.
- Move sheep down Alley 2 to Pen 2 then through back gate into Pen 1. Move sheep from Pen 1 into Alley 2 and place them in a holding pen along Alley 1 that is designated by the course director.

6. Special Task (2) Setup and hold –15 points

- Remove 5 fresh sheep from a holding pen designated by course director and move along Alley 1 to the gather area. Open handlers may accompany their dog to the gather area; advanced handlers cannot go past the open handler's post. Once the sheep are settled to the judge's satisfaction execute a call-off command to your dog and leave the field.

Remember, time will not end until all gates are returned to their original position.

Handlers will have 25 minutes to complete the course. A warning will be given at 10 minutes and 3 minutes