

Farm trial 1; arena 60' x 80'

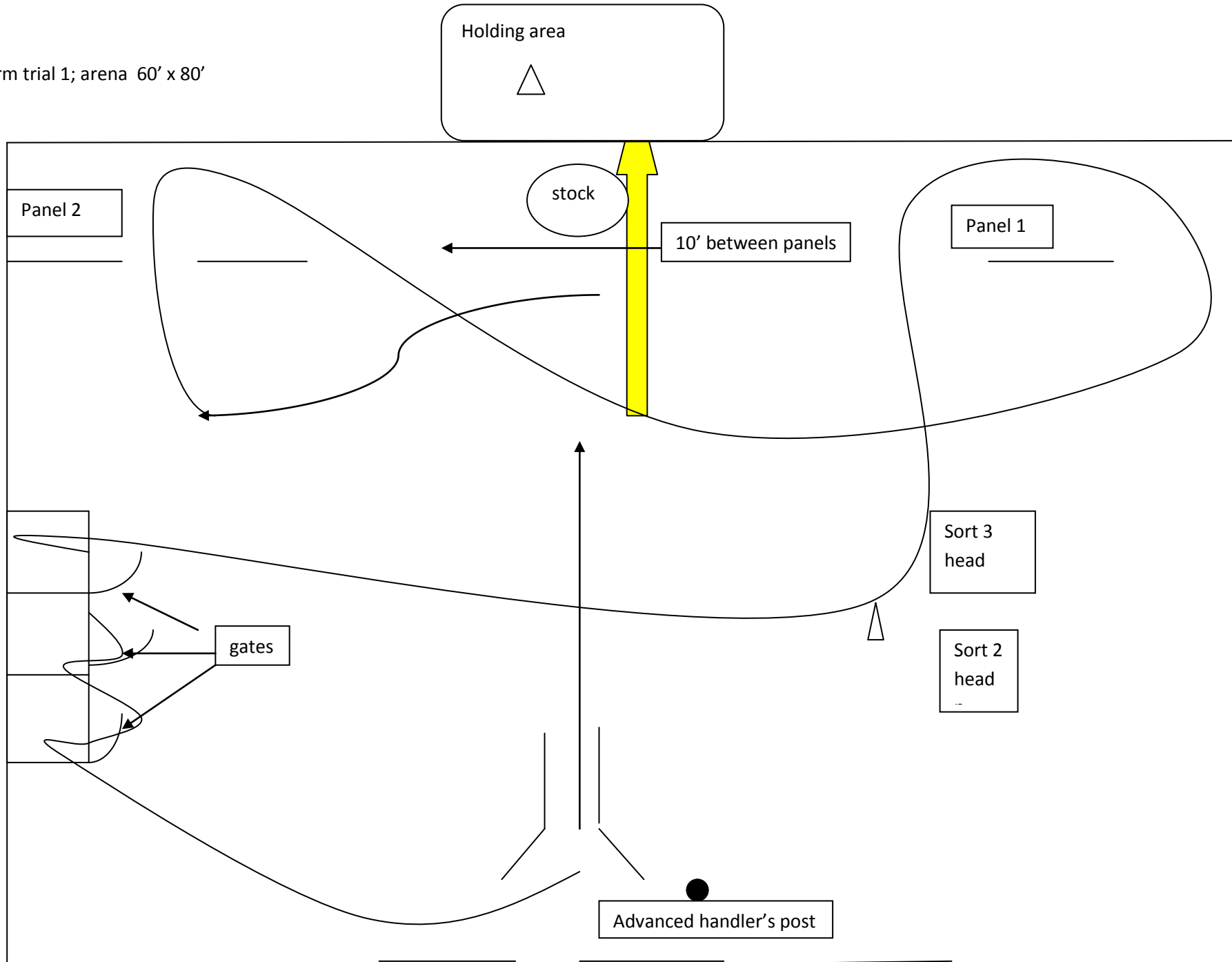

Center of arena is run away line drawing is NOT to scale

- The time limit is 20 minutes for open and 30 minutes for advanced.
- Ties will be broken by the gather.
- For safety, handlers must use the catwalks when working the chutes.
- All gates need to be closed after completion of task.
- Gates are all the same width of the pen.
- You must complete each task, before moving onto the next.
- Bitches in heat will run in order.

All Dogs Open and Advanced

- **Gather - 25 points**
 - Open handlers can walk halfway to livestock
 - Five head of stock from set out point
 - Move into in a clockwise direction thru Panel 1, continuing in a figure 8 pattern thru Panel 2 to a free standing pen for the sort
- **Sorting - 25 points**
 - Move three marked head into Pen 1
 - Close gate on Pen
 - Move other two head into Pen #2
 - Allow stock to settle, then move all back into open area
 -
- **Pen work - 25 points**
 - Take stock from sort pens to catch pens along side of arena
 - Move in and out of each of the 3 pens.
 -
- **Chute work - 25 points**
 - Move stock from pens to free standing chute
 - Move stock thru chute back towards holding area.
- **Specific Task 1 - 15 points**
 - Move stock in figure 8 between panels 2 & 1
- **Specific Task 2 - 15 points**
 - Move stock from set of three pens thru chute

Advanced Dogs Only

- Handlers must stay at the specified point 150' from the stock on the gather
 - Pick stock up from end of chute
 - and take the stock from the chute into holding area
 - spray

Drawing not to scale.

Farm trial 2 arena 60' x 60'

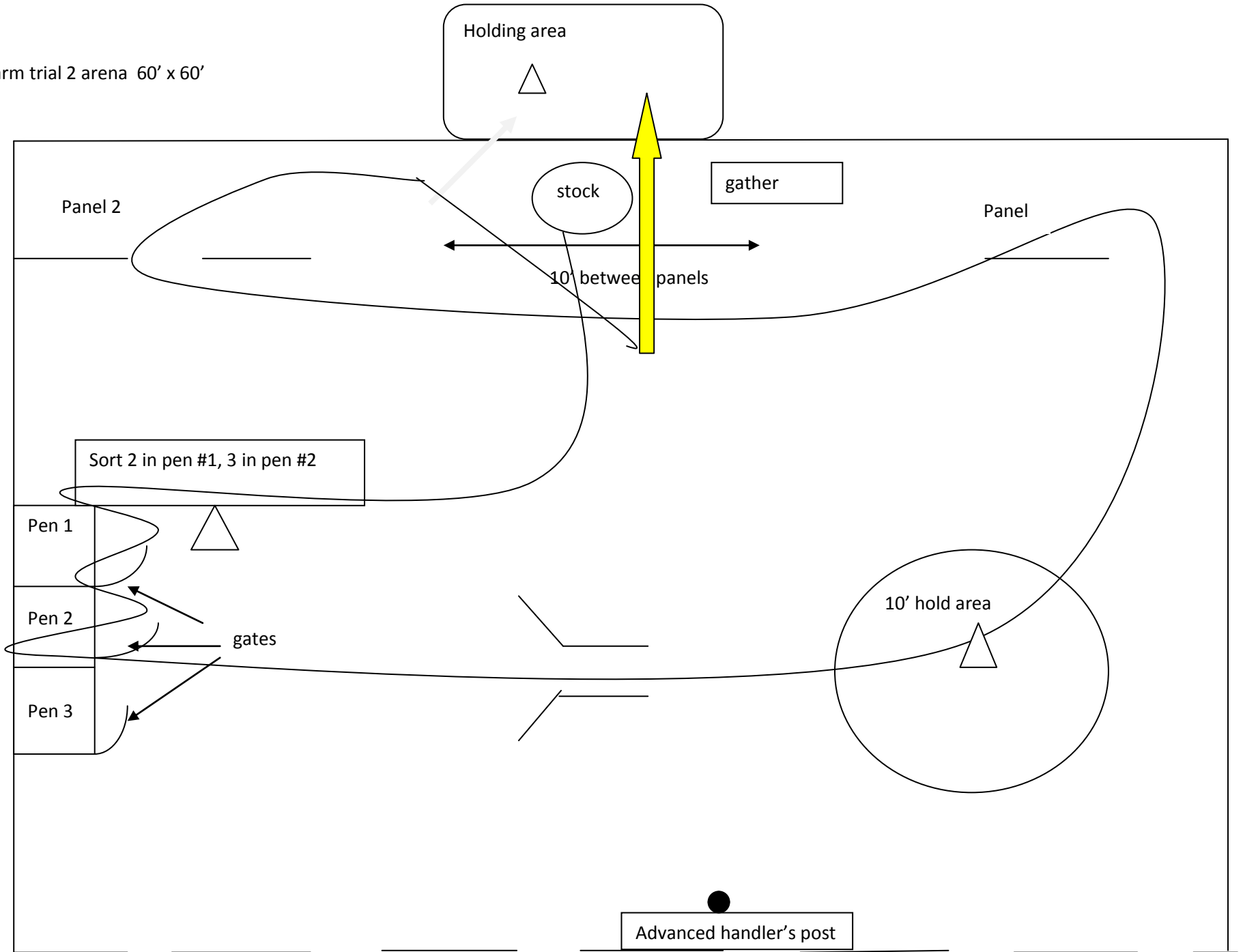

Center of arena is run away line

drawing is NOT to scale

- The time limit is 20 minutes for open and 30 minutes for advanced.
- Ties will be broken by the gather.
- For safety, handlers must use the catwalks when working the chutes.
- All gates need to be closed after completion of task.
- Gates are all the same width of the pen.
- You must complete each task, before moving onto the next.
- Bitches in heat will run in order.

All Dogs Open and Advanced

- **Gather - 25 points**
 - Open handlers can walk halfway to livestock
 - Five head of stock from set out point
 - Move into in a straight line from the gather to sort pens
- **Sorting - 25 points**
 - Move three marked head into Pen 1
 - Close gate on Pen
 - Move other two head into Pen #2
- **Pen work - 25 points**
 - move all into pen #3
 - Allow stock to settle, then move all back into open area
- **Chute work - 25 points**
 - Take stock from sort pens thru Y chute
 - Move stock thru chute into holding area.
- **Specific Task 1 - 15 points**
 - Move stock in figure 8 between panels 1& 2
- **Specific Task 2 - 15 points**
 - Hold all stock in 10' marked area

Advanced Dogs Only

- **Handlers must stay at the specified point 150' from the stock on the gather**
 - **Pick stock up from end figure 8**
 - **and take the stock into holding area**
 - **check/trim wings**

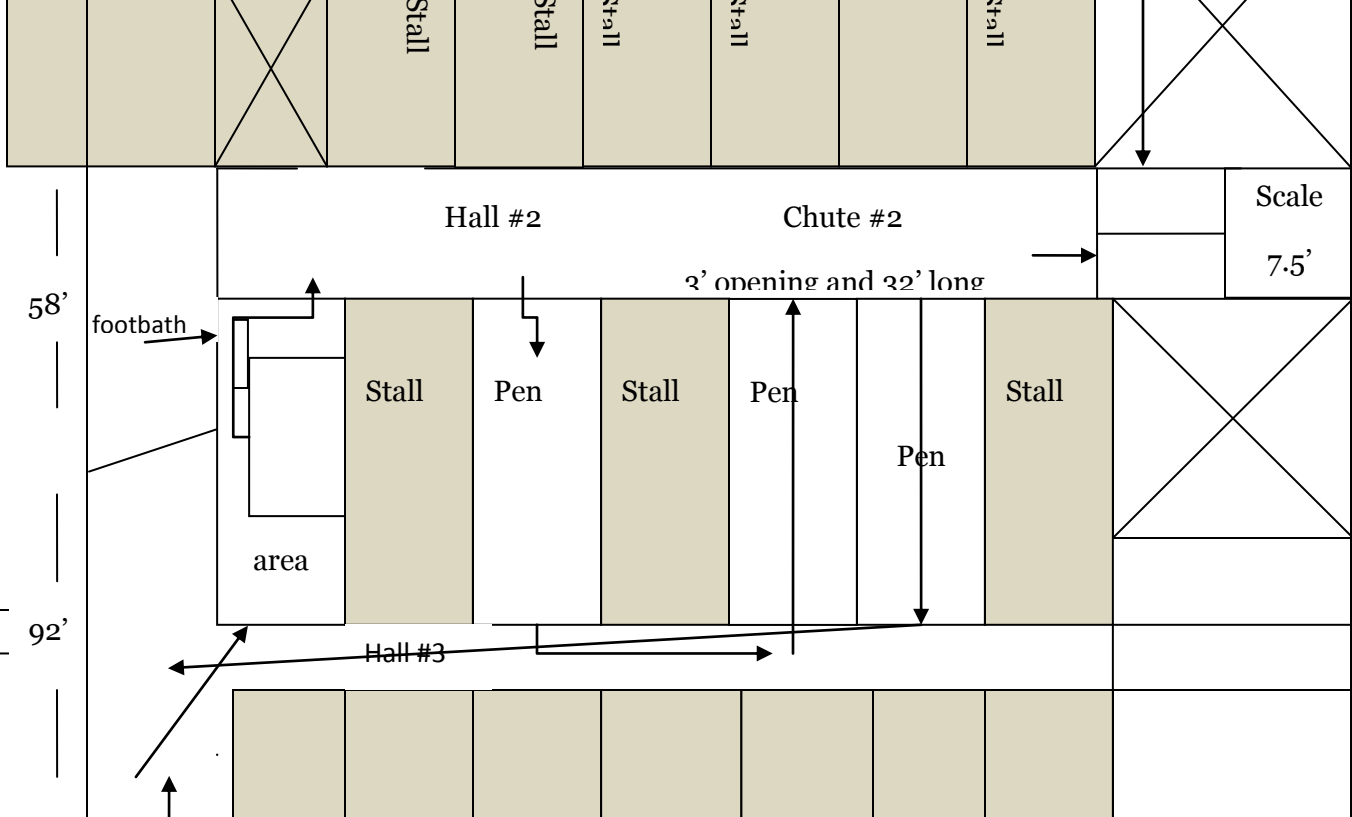

Gather 150' from stock
 Open handlers may position themselves half the distance between the dog and the stock

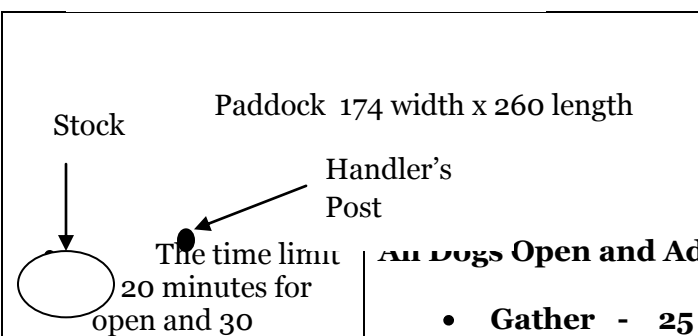

The time limit is 20 minutes for open and 30 minutes for advanced.

All Dogs Open and Advanced

- **Gather - 25 points**
 - Open handlers can walk halfway to livestock
 - Five head of stock from the paddock
 - Move into Ally #1
- **Sorting - 25 points**
 - Move stock down Hall #3 and into pen marked "Tagging Area"

Ally #1
 14'
 x
 25'

Sale Barn

- For safety, handlers must use the catwalks when working the chutes.
- All gates need to be closed after completion of task.
- Gates are all the same width of the pen.
- You must complete each task, before moving onto the next.
- Bitches in heat will run in order.

- Close gate on Pen
- Sort three marked head into the chute
- **Chute work - 25 points**
 - Move other two head into chute
 - Move stock through Chute #2, with footbath
 - Into Hall #2
- **Pen work - 25 points**
 - Up Hall #2 to 3rd pen on right
 - Move thru pen to other side and into Hall #3
 - Turn left and move stock into 3rd pen on left
 - Move thru pen and out into Hall #3, turn left and move stock into completing a figure 8 pattern
- **Specific Task 1 - 15 points**
 - Move stock down Hall #3 and into Hall #1
- **Specific Task 2 - 15 points**
 - Load stock on the trailer
 - Close the trailer gate (course ends when the trailer gate is closed)

Advanced Dogs Only

- Handlers must stay at the specified point 150' from the stock on the gather
 - Close the trailer gate from above, then open trailer gate
 - and take the stock from the trailer, down Hall #1 and Hall #2 through Chute #2 – this is still part of Specific Task 2
- Load stock onto scale and close scale gate (trial ends when the scale gate is closed) – this is still part of Specific Task 2

Drawing not to scale.

Chute #1
2' opening and 22' long

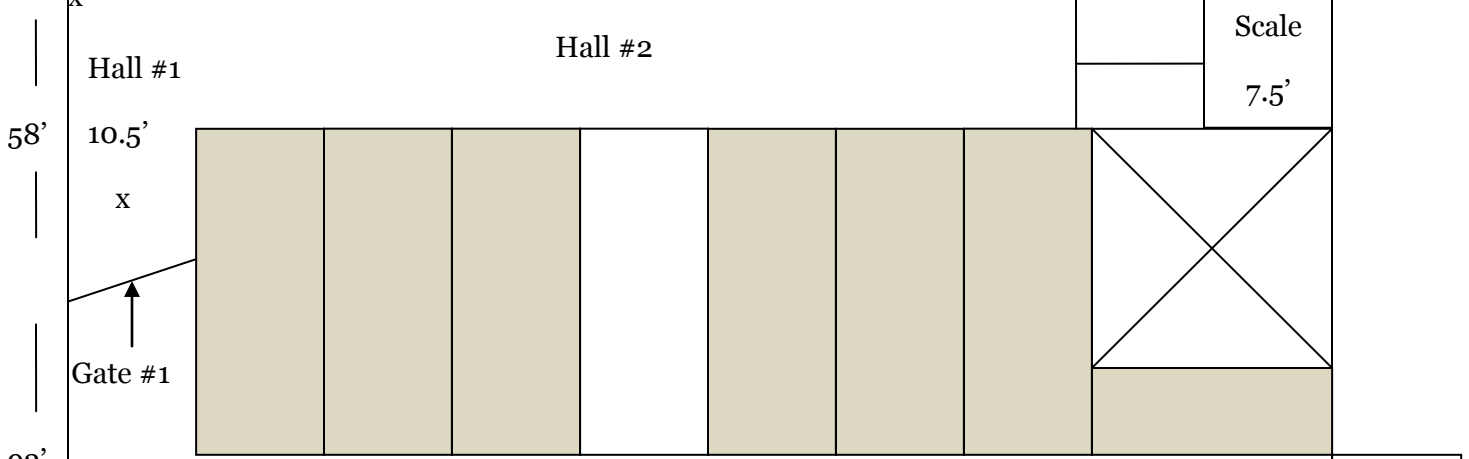
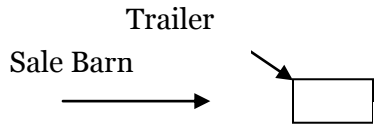
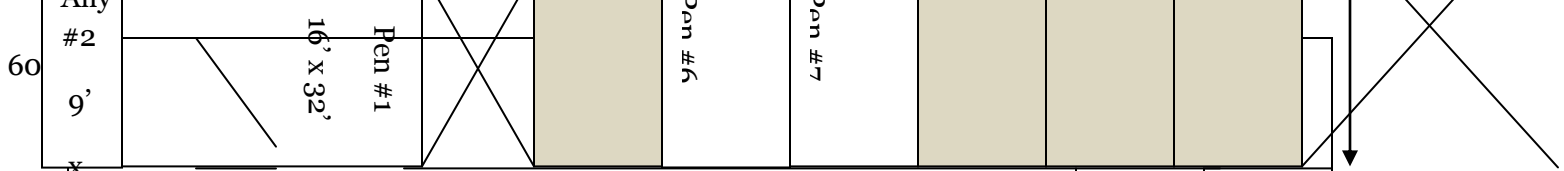

Gather 150' from stock
Open handlers may position themselves half the distance between the dog and the stock

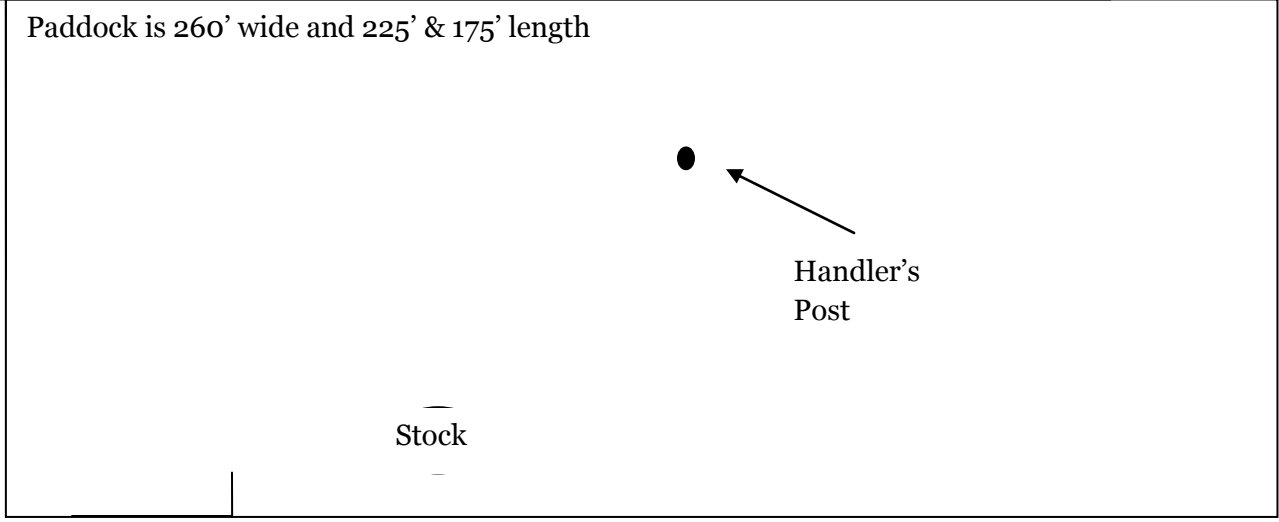
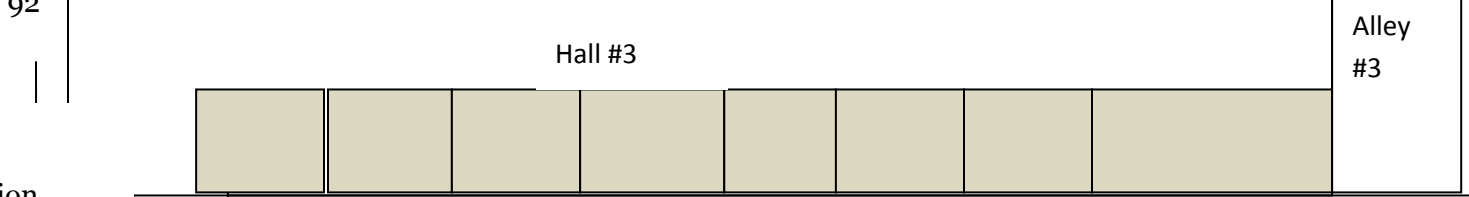

- The time limit is 20 minutes for open and 30 minutes for advanced.
- Ties will be broken by the gather.
- For safety, handlers must use the catwalks when working the chutes.
- All gates need to be closed after completion of task.
- Gates are all the same width of the pen.
- You must complete each task, before moving onto the next.
- Bitches in heat will run in order.

All Dogs Open and Advanced

- **Gather - 25 points**
 - Open handlers can walk halfway to livestock
 - Five head of stock from the paddock
 - Move into Ally #3
- **Pen work - 25 points**
 - Down Hall #3 to 4th pen on right
 - Move thru pen to other side and into Hall #2
- **Sorting - 25 points**
 - Move three marked head into Pen #6
 - Close gate on Pen
 - Move other two head into Pen #7
 - Allow stock to settle, then move all back into Hall #2
- **Chute work - 25 points**
 - Move stock into Pen #1
 - Move stock into chute (head catch will be closed)
 - Open head catch and release stock back into Hall #2
- **Specific Task 1 - 15 points**
 - Move stock down Hall #2 and into Hall #1
- **Specific Task 2 - 15 points**
 - Load stock on the trailer
 - Close the trailer gate (course ends when the trailer gate is closed)

Advanced Dogs Only

- Handlers must stay at the specified point 150' from the stock on the gather
 - Close the trailer gate from above, then open trailer gate
 - and take the stock from the trailer, down Hall #1 and Hall #2 through Chute #2 – this is still part of Specific Task 2
- Load stock onto scale and close scale gate (trial ends when the scale gate is closed) – this is still part of Specific Task 2

Drawing not to scale.